

vtech[®]

User's Manual

**Learn & Discover
Pretty Party Playset™**



© 2014 VTech
Printed in China
91-002936-004 ^{US}

Dear Parent,

Ever notice the look on your baby's face when they learn something new through their own discovery? These self-accomplished moments are a parent's greatest reward. To help fulfill them, **VTech**[®] created the **Infant Learning**[®] series of toys.

These unique interactive learning toys directly respond to what children do naturally – play! Using innovative technology, these toys react to baby's interactions, making each play experience fun and unique as they learn age-appropriate concepts like first words, numbers, shapes, colors and music. More importantly, **VTech**[®]'s **Infant Learning**[®] toys develop baby's mental and physical abilities by inspiring, engaging and teaching.

At **VTech**[®], we know that a child has the ability to do great things. That's why all of our electronic learning products are uniquely designed to develop a child's mind and allow them to learn to the best of their ability. We thank you for trusting **VTech**[®] with the important job of helping your child learn and grow!

Sincerely,

Your friends at **VTech**[®]

To learn more about the **Infant Learning**[®] series and other **VTech**[®] toys, visit www.vtechkids.com

INTRODUCTION

Thank you for purchasing the **VTech® Learn & Discover Pretty Party Playset™**.

Play and learn with the **Learn & Discover Pretty Party Playset™** by **VTech®**. The interactive playset includes a pitcher of pretend lemonade, cups and sweet treats to share with friends. Put the playset pieces on the tray to see the pitcher and tray light-up and learn about colors, shapes, food and more!

SHAPE SORTING SLOTS

**ON/OFF/VOLUME
CONTROL SWITCH**

SHAPE SORTING TREATS

TWO CUPS

LIGHT-UP PITCHER

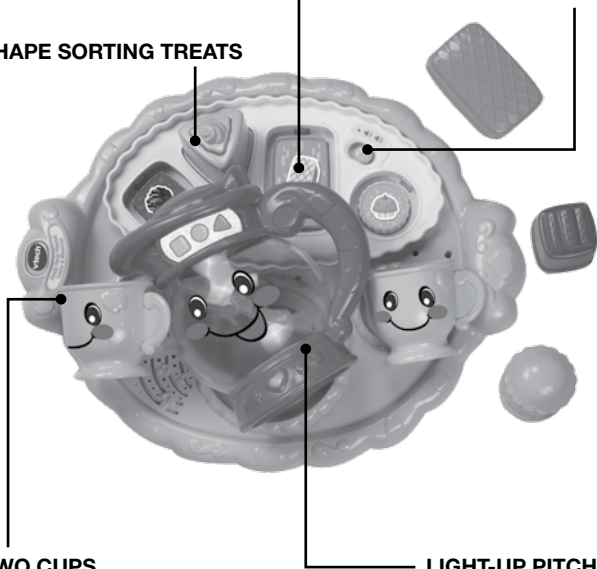

INCLUDED IN THIS PACKAGE

- One VTech® Learn & Discover Pretty Party Playset™ electronic tray
- One pitcher
- Two cups
- Four shape sorting treats
- One user's manual

WARNING: All packing materials, such as tape, plastic sheets, packaging locks, wire ties and tags are not part of this toy, and should be discarded for your child's safety.

ATTENTION: Pour la sécurité de votre enfant, débarrassez-vous de tous les produits d'emballage tels que rubans adhésifs, feuilles de plastique, attaches et étiquettes. Ils ne font pas partie du jouet.

NOTE: Please keep this user's manual as it contains important information.

Please cut and discard the cord that attaches the treat to the product. The cords are not part of this toy and should be discarded for your child's safety.

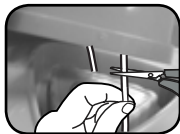

Unlock the packaging locks:

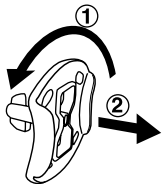

- ① Rotate the packing locks 90 degrees counter-clockwise
- ② Pull out the packing locks

GETTING STARTED

BATTERY INSTALLATION

1. Make sure the unit is turned **OFF**.
2. Locate the battery cover on the bottom of the electronic tray. Use a screwdriver to loosen the screw.
3. Install 2 new 'AA' (AM-3/LR6) batteries following the diagram inside the battery box. (The use of new alkaline batteries is recommended for maximum performance.)
4. Replace the battery cover and tighten the screw to secure the battery cover.

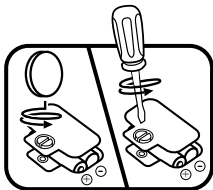



BATTERY NOTICE

- Use new alkaline batteries for maximum performance.
- Use only batteries of the same or equivalent type as recommended.
- Do not mix different types of batteries: alkaline, standard (carbon-zinc) or rechargeable (Ni-Cd, Ni-MH), or new and used batteries.
- Do not use damaged batteries.
- Insert batteries with the correct polarity.
- Do not short-circuit the battery terminals.
- Remove exhausted batteries from the toy.
- Remove batteries during long periods of non-use.
- Do not dispose of batteries in fire.
- Do not charge non-rechargeable batteries.
- Remove rechargeable batteries from the toy before charging (if removable).
- Rechargeable batteries are only to be charged under adult supervision.

PRODUCT FEATURES

1. ON/OFF/VOLUME CONTROL SWITCH

To turn the unit **ON**, slide the **ON/OFF/VOLUME CONTROL SWITCH** to the **LOW VOLUME** () or **HIGH VOLUME**() position. To turn the unit **OFF**, slide the **ON/OFF/VOLUME CONTROL SWITCH** to the **OFF** (●) position.



2. AUTOMATIC SHUT-OFF

To preserve battery life, the **VTech® Learn & Discover Pretty Party Playset™** will automatically power-down after approximately one minute without input. The unit can be turned on again by inserting or removing one of the play pieces from the tray or by pressing any button.

ACTIVITIES

1. Slide the **on/off/volume control switch** to turn the unit on. You will hear a fun sound, a song and a phrase. The light will flash with the sounds.



2. Press the **shape buttons** to learn shapes or hear playful sing-along songs and fun sounds. The light will flash with sounds.



3. Press the **light-up button** to hear a playful phrase, fun sounds or a sing-along song. The light will flash with sounds.



4. Insert the **pitcher** or the **treats** into the corresponding slot on the tray to learn colors and objects and hear playful sing-along songs. The light will flash with sounds.



5. Remove the **pitcher** or the **treats** from the tray to hear playful phrases and melodies. The light will flash with sounds.

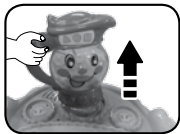

6. If there is no input to the tray after approximately 8 seconds, you will hear a random question. After another 8 seconds without input, you will hear a sing-along song. If there is no input after another 8 seconds, the unit will play a short tune and automatically power down.

SUNG SONG LYRICS

SONG 1

It's time for a party.
There are lots of treats.
All different shapes.
Yummy, I like party time.

SONG 2

It's time for a party.
We'll pour some lemonade.
And eat some treats.
Spending time with you is sweet!

SONG 3

Cookies are a sweet and crunchy treat!

SONG 4

Yum, cheesecake is a rich and creamy little treat!

SONG 5

The cake smells delicious, can't wait to take a bite!

SONG 6

Who doesn't love a cupcake with sprinkles on top?

MELODY LIST

1. Boys & Girls Go Out to Play
2. White Coral Bells
3. Bicycle Built for Two
4. While Strolling Through the Park
5. Lavender's Blue
6. A-Tisket, A-Tasket
7. Mary, Mary Quite Contrary
8. Little Miss Muffet
9. A, B, C Tumble Down D
10. Good Morning Merry Sunshine
11. Hot Cross Buns
12. Peas Porridge Hot
13. Little Bo Peep
14. Muffin Man
15. Polly Put the Kettle On
16. Simple Simon
17. Sing a Song of Sixpence
18. Three Little Kittens
19. Ring Around the Rosy
20. Pop! Goes the Weasel

CARE & MAINTENANCE

1. Keep the unit clean by wiping it with a slightly damp cloth.
2. Keep the unit out of direct sunlight and away from any direct heat source.
3. Remove the batteries when the unit will not be in use for an extended period of time.
4. Do not drop the unit on hard surfaces and do not expose the unit to moisture or water.

TROUBLESHOOTING

If for some reason the program/activity stops working or malfunctions, please follow these steps:

1. Please turn the unit **OFF**.
2. Interrupt the power supply by removing the batteries.
3. Let the unit stand for a few minutes, then replace the batteries.
4. Turn the unit **ON**. The unit should now be ready to play again.
5. If the product still does not work, replace with an entire set of new batteries.

If the problem persists, please call our Consumer Services Department at 1-800-521-2010 in the U.S. or 1-877-352-8697 in Canada, and a service representative will be happy to help you.

For information on this product's warranty, please call **VTech®** at 1-800-521-2010 in the U.S. or 1-877-352-8697 in Canada.

IMPORTANT NOTE:

Creating and developing Infant Learning products is accompanied by a responsibility that we at **VTech®** take very seriously. We make every effort to ensure the accuracy of the information, which forms the value of our products. However, errors sometimes can occur. It is important for you to know that we stand behind our products and encourage you to call our Consumer Services Department at 1-800-521-2010 in the U.S. or 1-877-352-8697 in Canada, with any problems and/or suggestions that you might have. A service representative will be happy to help you.

FCC Information:

Note: This equipment has been tested and found to comply with the limits for a Class B digital device, pursuant to Part 15 of the FCC Rules. These limits are designed to provide reasonable protection against harmful interference in a residential installation. This equipment generates, uses and can radiate radio frequency energy and, if not installed and used in accordance with the instructions, may cause harmful interference to radio communications. However, there is no guarantee that interference will not occur in a particular installation.

If this equipment does cause harmful interference to radio or television reception, which can be determined by turning the equipment off and on, the user is encouraged to try to correct the interference by one or more of the following measures:

- Reorient or relocate the receiving antenna.
- Increase the separation between the equipment and receiver.
- Connect the equipment into an outlet on a circuit different from that to which the receiver is connected.
- Consult the dealer or an experienced radio/TV technician for help.

THIS DEVICE COMPLIES WITH PART 15 OF THE FCC RULES. OPERATION IS SUBJECT TO THE FOLLOWING TWO CONDITIONS: (1) THIS DEVICE MAY NOT CAUSE HARMFUL INTERFERENCE, AND (2) THIS DEVICE MUST ACCEPT ANY INTERFERENCE RECEIVED, INCLUDING INTERFERENCE THAT MAY CAUSE UNDESIRE OPERATION.

CAN ICES-3 (B)/NMB-3(B)

Caution : changes or modifications not expressly approved by the party responsible for compliance could void the user's authority to operate the equipment.

